

Hardware Included

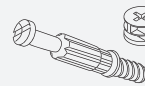

Adjustable Feet
Screws **x 16**



Cam & Pin **x 27**



28mm
Wood Screws **x 4**



14mm
Wood Screws **x 32**



1 inch nail **x 30**

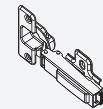

Door
Hinges **x 4**



Sticker on
Caps **x 8**

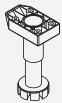

Adjustable Feet **x 4**



Handle **x 2**



90° Angle
Bracket **x 2***



Handle Screws **x 4**



Door Buffer **x 4**



Sticker on
Cam Caps **x 7**

*Angle bracket is used to attach the benchtop to the cabinet.

Tools you will need

To put your cabinets together you will need the following tools.

Cordless drill with:

- Number 2 Phillips head bit
- 4.5mm drill bit
- Number 12 countersinking drill bit

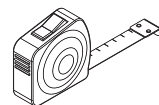
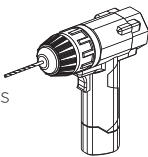

Tape
Measure



Pencil



Hammer

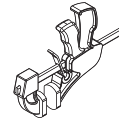

Clamps
(Quick Release)



Safety
Gear

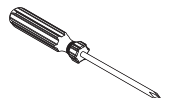

Phillips Head
Screw Driver

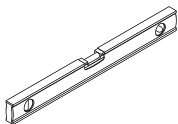

Spirit Level
(900mm recommended)

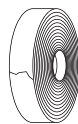

Masking
Tape

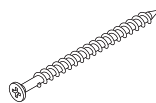

65mm
Wood Screw

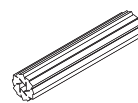

Wall Fixing
(If Necessary)

Important notice

- Make sure you leave plumbing and electrical work to qualified trades people. Never try this yourself.
- If you have any questions contact us on **1800 666 078** Monday to Friday between 8:00am and 6:00pm AEST or email: **info@flatpax.com.au**.

900mm 2 DOOR FLOOR CUPBOARD

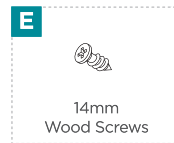
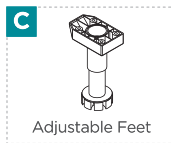
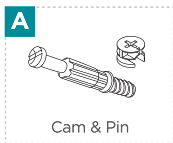

STEP 1

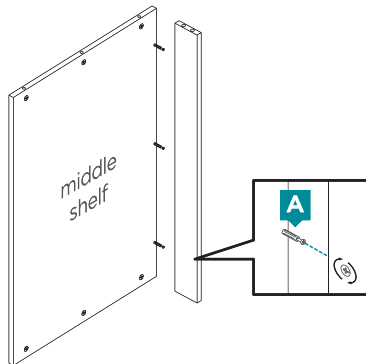

STEP 2

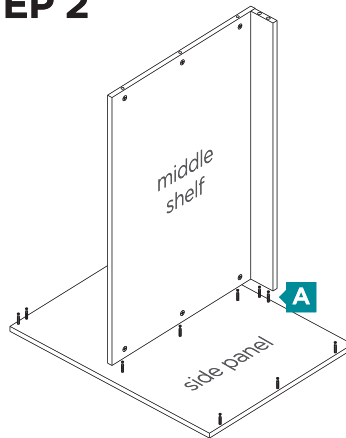

STEP 3

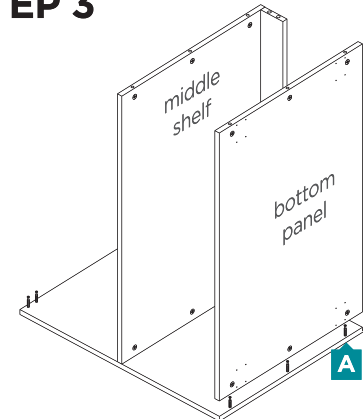

note: Make sure the pre-drilled holes for the adjustable feet are facing outwards.

STEP 4

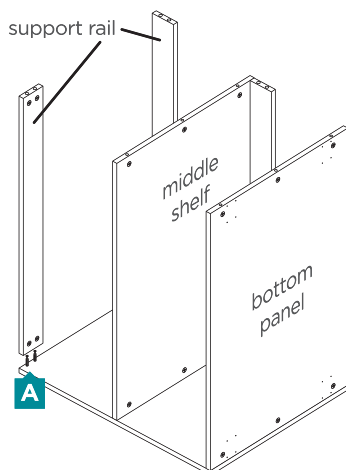

STEP 5

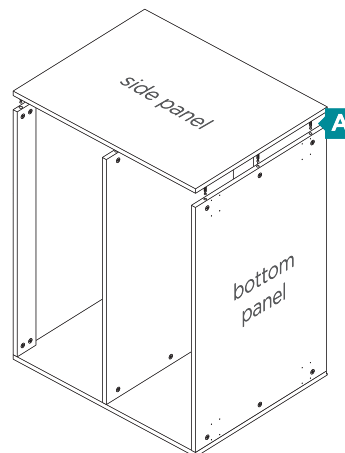

STEP 6

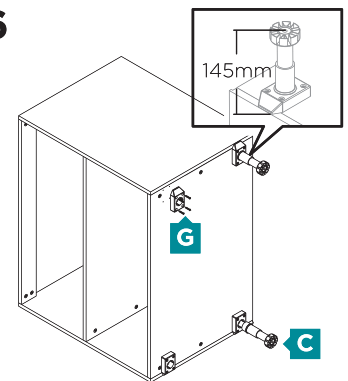

stop: If this cabinet is to be installed at the end of the run refer to the kickboard instructions now on the correct placement of the feet. Set the height of the adjustable feet to 145mm to suit the kickboard.

STEP 7

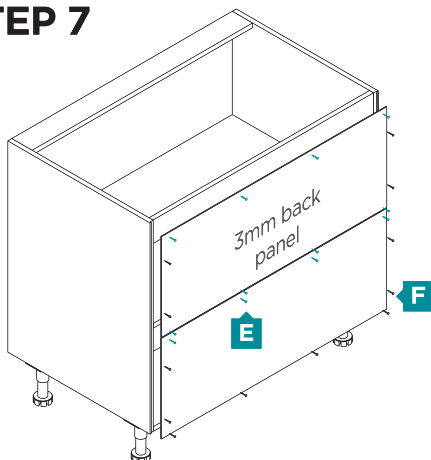

note: The white side of the back panel should face inside the cabinet.

STEP 8

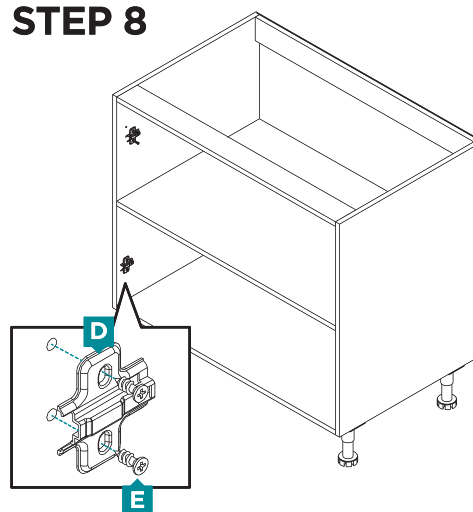

STEP 9

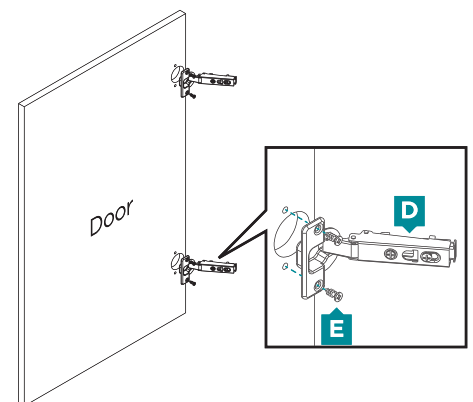

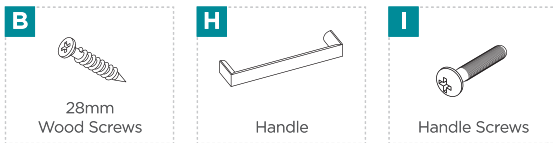

STEP 10

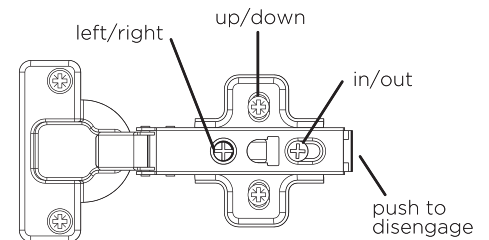
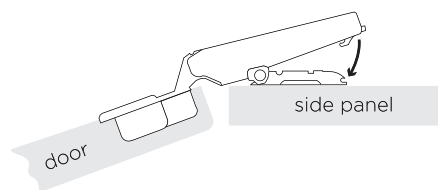
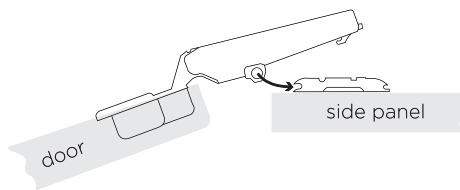

Clip the door onto the hinge plates.

Now push down to clip hinge securely together.

To align doors adjust marked screws.

STEP 11

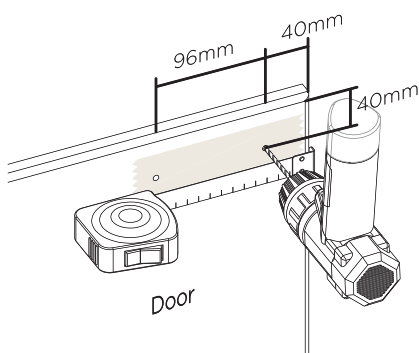

Place masking tape on both sides of the door where holes will be drilled to avoid chipping. Pre-drill using 4.5mm drill bit

STEP 12

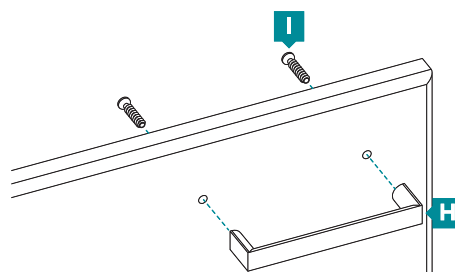

STEP 13

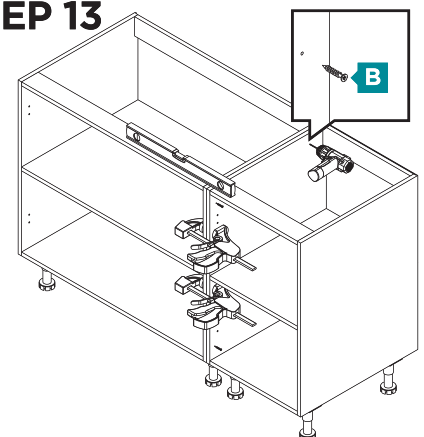

Check cabinets are level then clamp together. Pre-drill using 2mm drill bit and attach cabinets together.

STEP 14

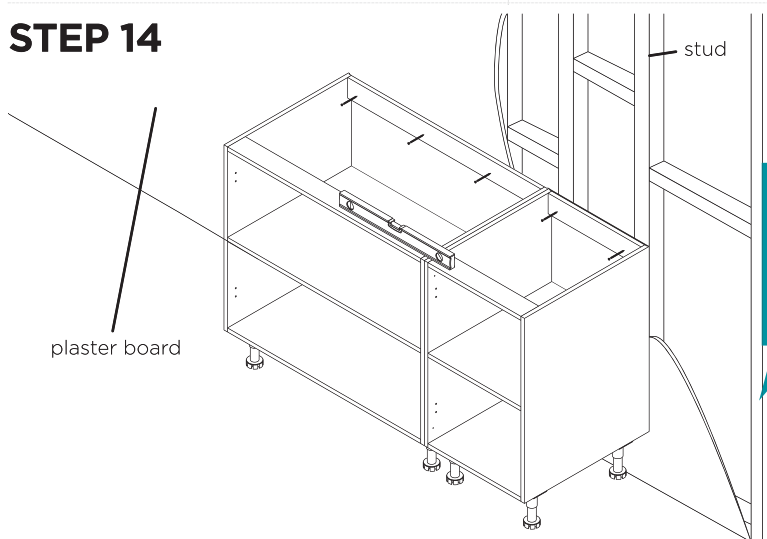

Caution: Please ensure all cabinets are screwed into your timber stud wall using a minimum of 65mm timber screws. If attaching to concrete, brick, steel or any other substrates seek advice from your hardware specialist.